

ESIM | How to Activate ESIM – Samsung (Internet Connection is required)

1

Go to "Settings"
Select "Connections"

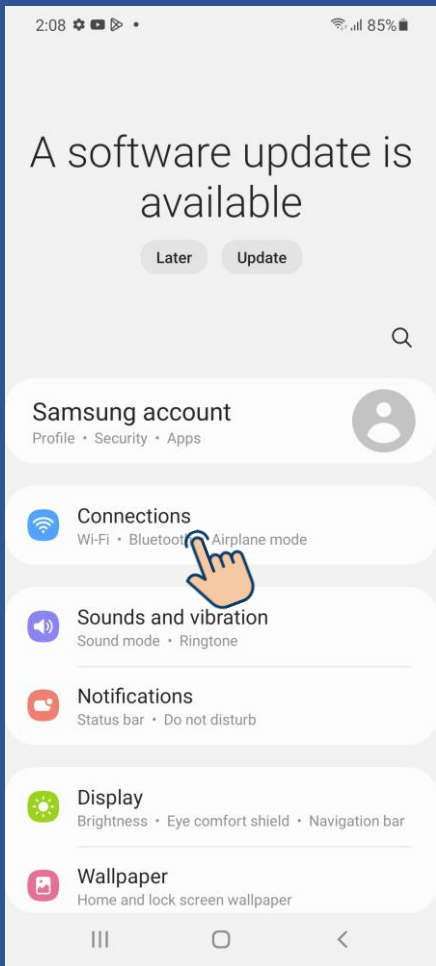

2

Select "SIM card manager"

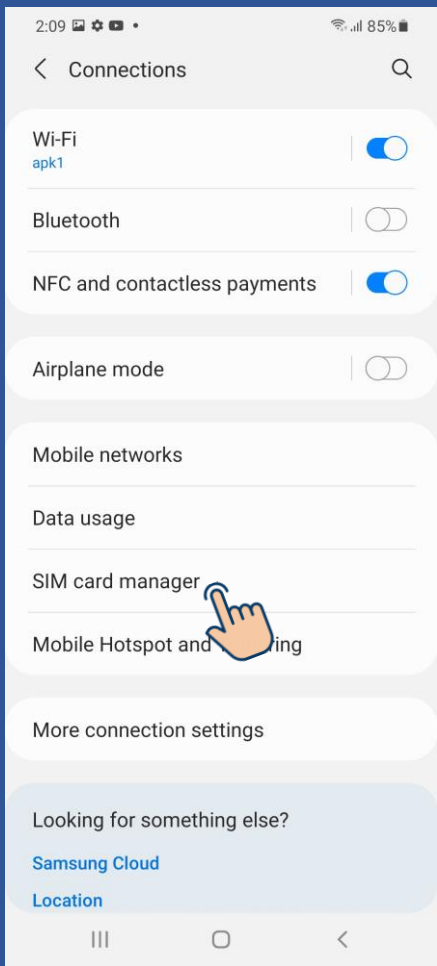

3

Key-in confirmation from
ESIM activation voucher

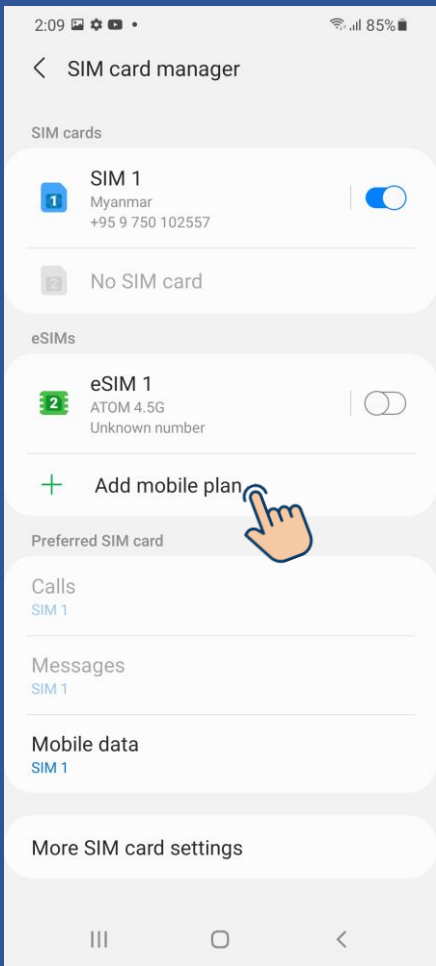

4

Select Scan carrier QR code

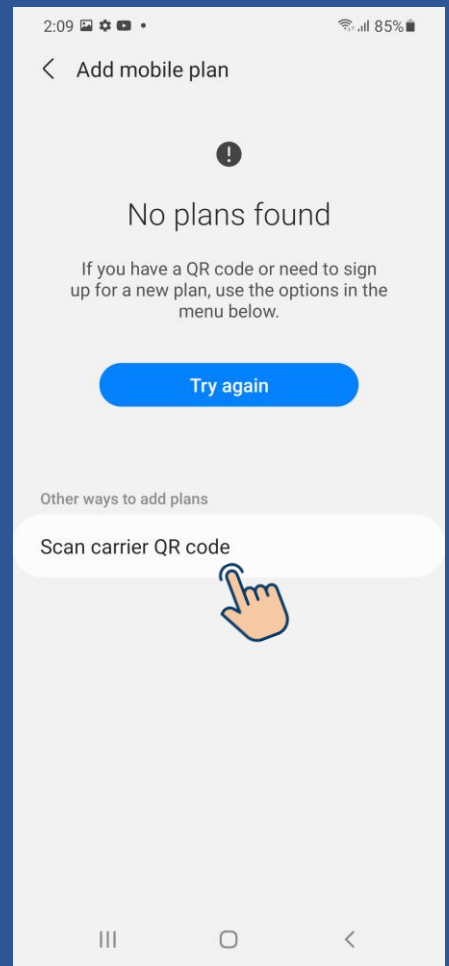

ESIM | How to Activate ESIM – Samsung (Internet Connection is required)

5

Scan QR from ESIM activation voucher



6

Key-in confirmation from ESIM activation voucher

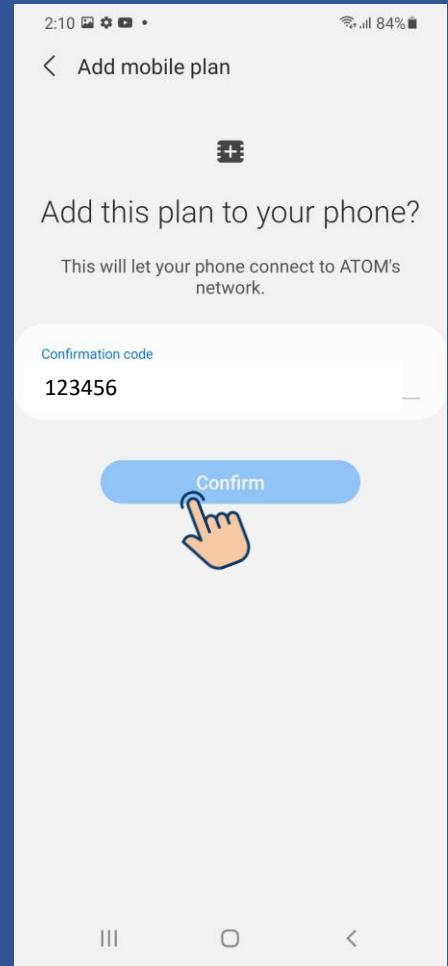

7

Wait until the process has completed

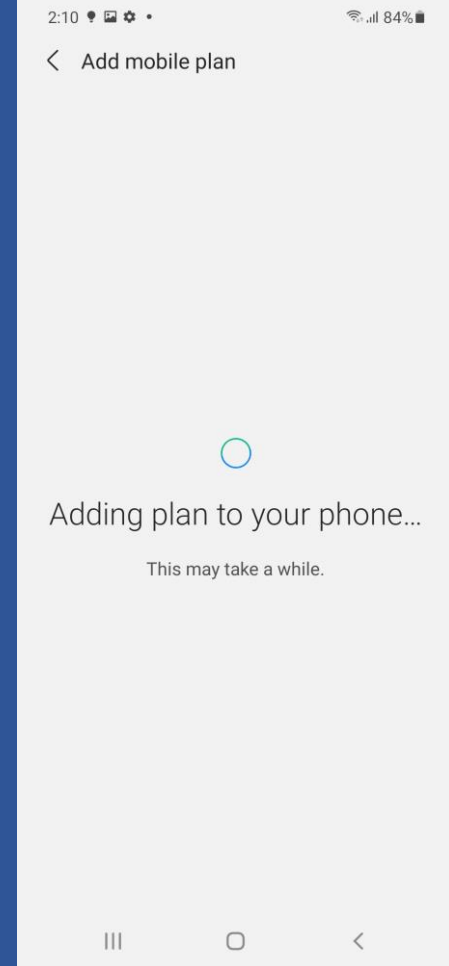

8

ESIM is now ready to use Mobile usage

